

Installation and Operating Instructions

Models:

T4-13DM-SLI-1

T4-14DM-LOW-1

T4-15DM-CUR-1

T4-18GBOX

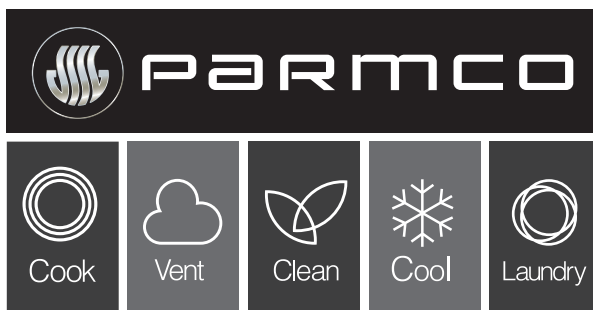

p: 09 573 5678
f: 09 573 5699
e: sales@parmco.co.nz
w: www.parmco.co.nz

Parmco Appliances

extended 7 year

warranty

The Warranty:

- This appliance is intended for domestic use in the owners' home. Use of the appliance for commercial purposes will limit the warranty period (please see Parmco website for commercial details).
- Subject to the terms and conditions contained within this warranty, if the product is not of Acceptable Quality (as defined in the Consumer Guarantees Act) within 7 years of the date of original purchase, then Parmco Sales undertakes to repair or, at its sole discretion, replace the product.
- The warranty does not cover the costs of transport, mileage or travelling time if the product is located beyond 30km of a recognised Service Agent.
- This warranty is offered as an extra benefit, and does not affect other legal rights, which can not be modified or excluded by agreement.
- This warranty only applies to goods supplied and installed in the North and South Islands of New Zealand.
- The provisions of this warranty are in addition to the rights and remedies available to consumers under the Consumer Guarantees Act 1993.

Product _____ Date of purchase _____
Serial Number _____
Dealer / Retailers Name _____

Please retain this Warranty card together with receipt or other proof of purchase date when seeking service during the warranty period

Please contact Parmco at 09 573 5678 if your appliance needs servicing under warranty. Please have your model number and proof of purchase ready. Warranty repairs must be authorized by Parmco.



The Warranty is not valid:

- If the product is not installed and operated in accordance with the operating instructions.
- If the product is not installed to comply with the electrical, gas, plumbing and other Regulations and Codes of Practice in New Zealand.
- If the product is operated on voltages or frequencies outside the normal range for domestic appliances in New Zealand.
- If the product is not used in normal domestic use, or if it is used in a business as defined in the Consumer Guarantees Act.
- If any serial number has been removed or defaced.
- If proof of date of purchase is not supplied, except at the sole discretion of Parmco Sales. Proof of purchase can be for the product itself, or if installed with a kitchen or house then proof of purchase can be from a Parmco reseller of products supplied by Parmco.
- If the products are purchased in a second hand condition from other parties (including but not limited to TradeMe, Sella, etc.)

Liability under this warranty will not be accepted for:

- Wear and tear caused by normal domestic use of the product.
- Damage in transport.
- Damage caused to the product by neglect, abuse, negligence, wilful act or misuse.
- Any costs associated with the repair, replacement, removal or reinstallation of products installed in a damaged condition.
- Any defect caused by accident, misuse, neglect, tampering with or unauthorised modifications of the appliance or any attempt at internal adjustment or repair by any person other than an Authorised Service Agent.
- Service calls that relate principally to the following:
 - Instruction on how to use the product.
 - Repair or replacement of house fuses, electrical wiring, gas fitting or plumbing.
 - Normal or scheduled maintenance including blocked filters or ducting.
 - Consumable items such as light bulbs.
 - Any damage to hobs caused by spills when cooking.
 - Any breakage or damage of glass items.
- Any damage caused by non recommended product used for cleaning, maintaining, lubricating or similar.
- Any aspect relating to the installation of the product, or damage caused during installation including blocked access for repair.
- Any third party (including reseller) or consequential loss or damage (direct or indirect) however arising.



Dear Valued Customer,

Thank you and congratulations on purchasing your new Parmco appliance.

All Parmco products are made to the highest quality and design standards. We are sure you will enjoy your new appliance.

As a note please read through these instructions carefully, as these will assist you in gaining a complete understanding of the functions and features offered by your appliance.

Please take special note of all detailed technical information and installation instructions. It is essential that you only allow a qualified technician to install this appliance to ensure the safety and reliability of this appliance.

Furthermore, not using appropriate personnel to install this appliance may affect any future warranty claims lodged, so please check with Parmco Appliances before any installation is carried out.

We hope you enjoy your new appliance. If you would like to find out more about this product or any other products in Parmco's extensive range, visit us on the web at www.parmco.co.nz.

Regards,
The Parmco Team



INDEX

| Content | Page |
|------------------------------|------|
| Important Safety Information | 4 |
| Features | 5 |
| Installation | 5 |
| Use and care | 7 |
| Maintenance | 9 |

IMPORTANT SAFETY INFORMATION



For best performance and to extend the life of your appliance we recommend that you read the instructions in this owners manual thoroughly before using your new appliance. It will provide you with all the information you need to ensure its safe installation, proper use and maintenance. Retain this owners manual for future reference.

To maintain the efficiency and safety of this appliance we recommend the following:

BEFORE USING THIS APPLIANCE

Read the instructions thoroughly

- Remove all plastic protective films on the appliance before operating the appliance.
- The brackets and screws to fix this canopy to the wall are provided and are fixed to the inside packaging. Please check that the brackets and screws are not discarded with the packaging
- This appliance is designed for non-commercial, household use only and must not be altered in any way.
- This appliance can only be used safely when it is correctly connected to an efficient earthing system in compliance with New Zealand Electrical Standards requirements.
- Before maintenance or cleaning, always ensure that the appliance is disconnected from the mains.
- Packaging items such as plastic bags, polystyrene, nails, etc that this appliance is delivered in are potentially dangerous, and therefore appropriate measure must be taken to prevent children from coming into contact with them.
- This appliance must only be used by adults. Make sure that children do not touch the controls or play with the appliance. Young children should be supervised to ensure they do not play with the appliance.
- This appliance is not intended for use by persons (including children) with reduced physical, sensory, or mental capabilities, or lack of experience and knowledge, unless they have been given supervision or instruction concerning the use of this appliance by a person responsible for their safety.
- The exposed parts of this appliance may heat up during the cooking process and remain hot for some time afterwards, even after it has been switched off. Keep children well away during operation and while the unit is cooling down.
- Keep the appliance thoroughly cleaned. Residues may cause fire risks.
- DO NOT use a steam cleaner to clean this appliance.
- Avoid improper or dangerous use of this appliance.
- Do not obstruct the ventilation or heat dissipation slots.
- This appliance is intended for indoor use only. Avoid exposing the appliance to atmospheric elements such as direct sunlight and rain.
- If the supply cord is damaged, it must be replaced by the a service agent or a similarly qualified person.

FEATURES

- Your canopy has been constructed using high quality materials.
- Your canopy is fitted with a powerful centrifugal fan and is equipped with a low noise electric motor.
- Your canopy produces strong suction to rapidly ventilate your kitchen environment and each model contains aluminium mesh filters designed to trap grease from the air as it is removed from your kitchen.
- You will enjoy halogen lighting from your appliance.

INSTALLATION

Step 1: The canopy should be placed at a minimum distance of 65cm above the cooking surface when placed above an electric hob and a minimum of 75cm above the cooking surface when placed above a gas cooktop (Fig 1).

Step 2: To install, drill the holes at the distance indicated (Fig2) in a level line, at the desired height. Insert the screws into the holes and fasten securely to the wall ensuring that the screws fix into material that has sufficient load capacity to hold the weight of the canopy.

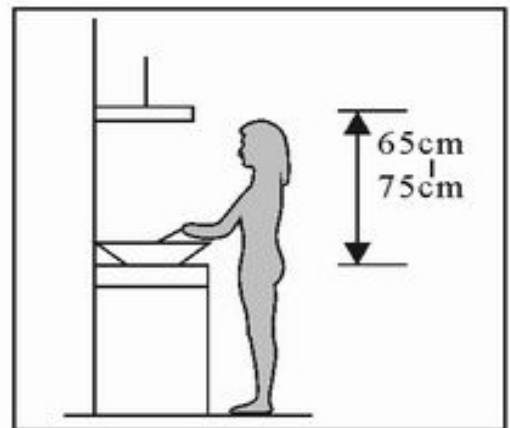

Fig 1

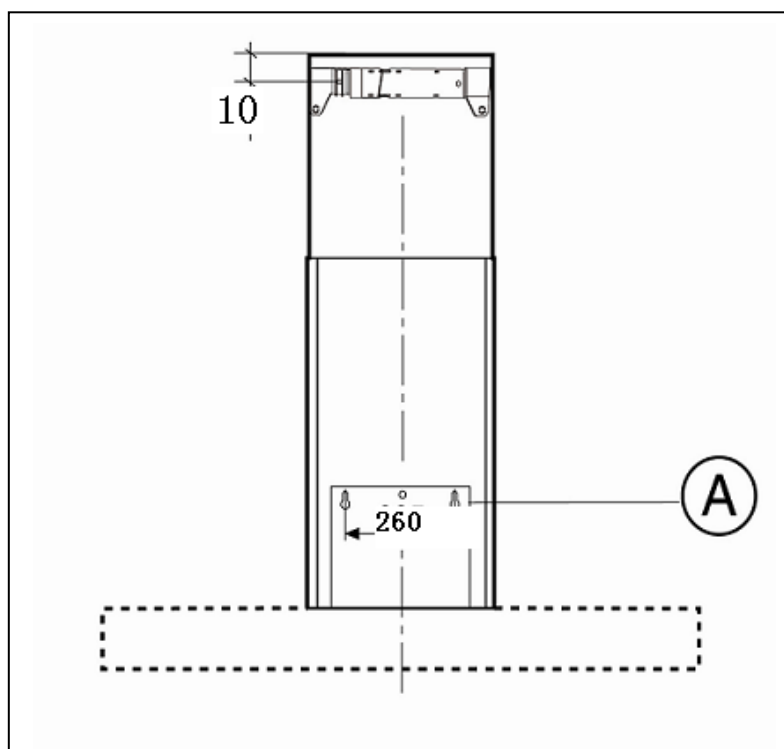

Fig 2

Step 3: To fix the two-piece chimney cowl, firstly ensure that the power supply has been placed within the dimensions of the flue cowl. Place the support bracket (A) for the upper section of the cowl on the wall at ceiling height (Fig 3). Ensure that the upper flue bracket is level and centred over the canopy. Fix bracket (A) firmly to the wall at the desired height.

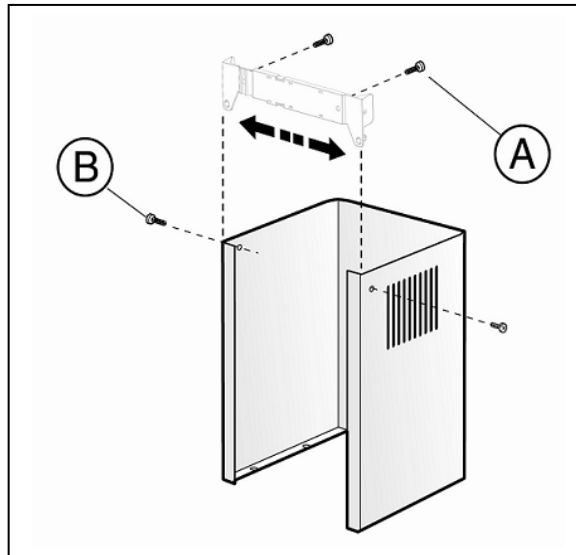

Fig 3

Step 4: Place the lower section of chimney cowl over the upper section and lower into place as shown in (Fig 4).

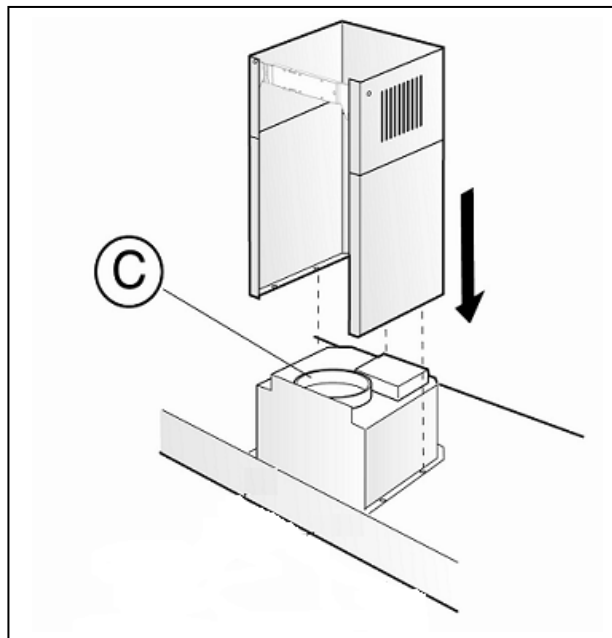

Fig 4

Step 5: Gently lift and extend the inner cowl up to the bracket height and fix to the bracket (A).

NOTE: If retrofitting these units into an existing building, it may be necessary to remove part of the scotia where the chimney cover meets the ceiling.



Installation of kitchen ventilation over electrical and gas cooktops must be undertaken in full accordance and reference to the relevant NZ building standards.

- Before installation, please ensure the area is clean to avoid remaining bits of broken wood and dust being sucked into the unit.
- The exhaust air must not be discharged into an operating smoke or exhaust flue, or into a shaft used for ventilating rooms in which a fireplace is located. The exhaust must not share the flue of any other appliance.
- After the initial installation, check that the unit has been installed level to avoid grease collection at one end.
- When the canopy is located above a gas appliance the minimum distance from the top of the cooking surface shall be 75cm and comply with the relevant NZ standards.
- When the canopy is located above an electric cooking surface the minimum distance from the top of the cooking surface shall be 65cm and comply with the relevant NZ standards.
- If installation instructions for the gas hob you are using specify a greater distance please follow the hob manufacturer's recommendation.
- Regulations concerning the discharge of air must be adhered to. Please refer to the relevant NZ standards.

USE AND CARE

DIGITAL CONTROLS

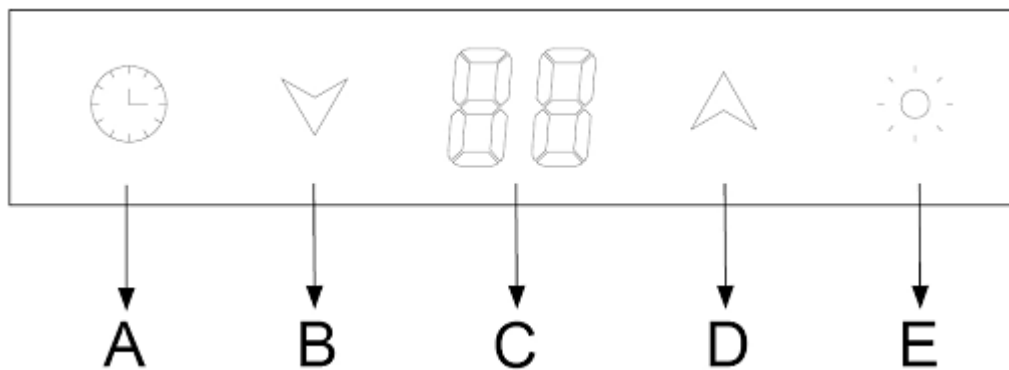

- A = Timer**
B = Fan speed DOWN
C = Fan speed indicator
D = Fan speed UP
E = Lights

Timer

To activate the timer, simply press the timer button (A). It will automatically default to 15 minutes duration. To increase/ decrease the timer duration, press the Fan speed buttons repeatedly (B) or (D) until the desired time is achieved. The timer will increase/decrease in 1 minute increments. The currently displayed timer setting will be displayed in the fan speed indicator (C).

Fan Speed

The current fan speed is indicated in the fan speed indicator (C). There are four speed settings:

F1 = Low suction

F2 = Light suction

F3 = Medium Suction

F4 = Maximum Suction

To **decrease** the fan speed, press (B) until desired fan speed is achieved.

To **increase** fan speed, press (D) until desired speed is achieved.

The slight “click” sound that can be heard when the fan is turned off is the draft prevention flap closing within the canopy.

Light

The light on/off cycle is controlled with the Light button (E). The units are equipped with halogen lights. The lights can be operated while the fan is operating. For ambient lighting, the lights can also be operated without the fan operating.

ELECTRONIC CONTROLS

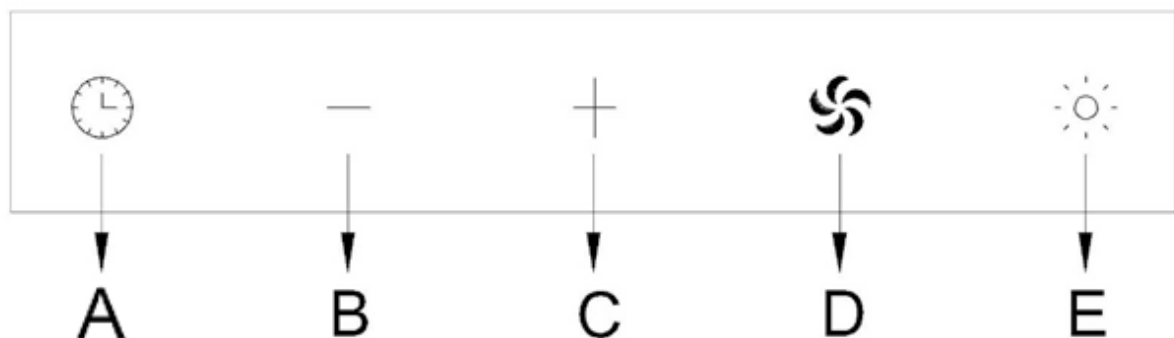

A = Timer

B = Fan speed DOWN

C = Fan speed UP

D = Fan speed TURBO

E = Lights

Timer

To activate the timer, press the timer button (A) while the fan is on. It will automatically default to 15 minutes duration. If you want to end ventilating prior to that duration, press the timer button again to stop.

Fan Speed

There are four speed settings.

To **decrease** the fan speed, press (B) until desired fan speed is achieved.

To **increase** fan speed, press (C) until desired speed is achieved.

To operate at **turbo** capacity, press (D).

The slight “click” sound that can be heard when the fan is turned off is the draft prevention flap closing within the canopy.

Light

The light on/off cycle is controlled with the Light button (E). The units are equipped with halogen lights. The lights can be operated while the fan is operating. For ambient lighting, the lights can also be operated without the fan operating.

MAINTENANCE

Remove the mesh filters by pushing in gently on the securing latches.

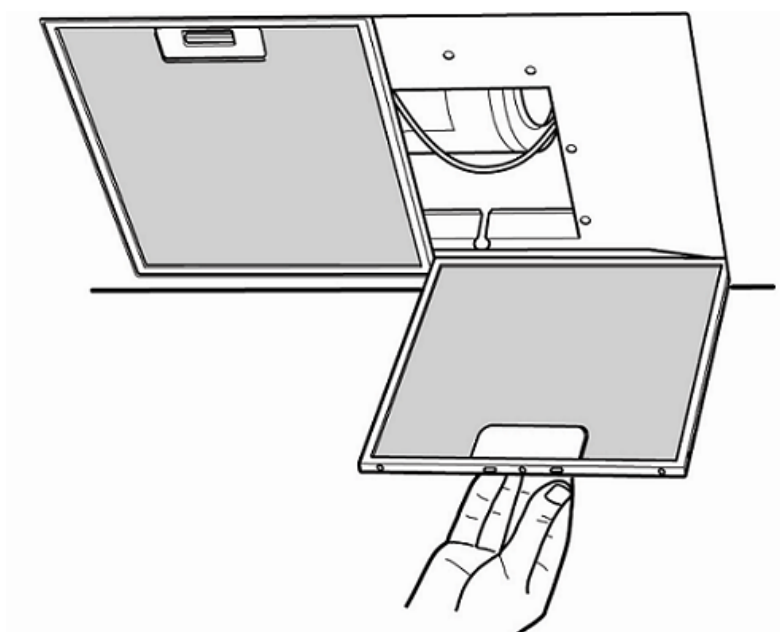

Cleaning the mesh grease filter

The mesh filter requires cleaning on a regular basis. Cooking styles with heavy grease and oil loading will require that the filters be cleaned more frequently.

The mesh filter is made of high-density aluminium. Please do not use a corrosive detergent on it. If using a dishwasher to clean filters, please ensure that a non-caustic detergent is used. Keeping this filter clean will keep the appliance running correctly.

Cleaning method

Method 1: Put the mesh filter into 40-50°C clean soapy water. Allow to soak for several minutes. Clean with a soft brush. Do not apply too much pressure as the mesh is delicate and will damage easily.

Method 2: If the detergent used in the dishwasher is of a non-caustic type, mesh filters can be put into a dishwasher. Set the temperature at around 60 °C.

Cleaning the canopy

- Before cleaning the appliance, please remember to turn off the power.
- To protect the main body from corrosion over a long period of time, it is essential that the canopy be cleaned with hot water plus non-corrosive detergent frequently.
- Do not use abrasive agents for cleaning, as this will damage the stainless steel body.
- Glass units can be cleaned using a good quality glass cleaner.
- Keep the motor and other spare parts free from water, as this will cause damage to the appliance.



It is essential that the unit be dried completely with a suitable soft cloth after cleaning as residual moisture can promote corrosion.

Replacing the lights

To replace the halogen lights, take a blunt object (eg, butter knife) and gently lever the lens cover off. There are 4 brackets holding up the cover.

Gently pull out the bulb, and replace it with a new one, being careful not to directly touch the new bulb with your fingers.

Fit the lens cover back on after replacing the bulb.